

Edible Town

Edible Community

Edible Landscape

Mag. (FH) Siegfried Tatschl©

Fruit for Thought – Edible Living Environments

Lust auf Obst – Essbare Lebensräume®

**What Does The Town Taste
Like?**

**What Does The Community
Taste Like?**

- What does Brno taste like?
- What does Lassees taste like?

Taste and see!



This is what Barcelona tastes like!

Edible Towns and Landscapes As Images And Counterpoints

Increasingly uniform design of living
environments and fields

Sealing off of the
environment

Clear cutting

Edible Town

Edible: Eat = emotional character

= an event

= positive association

Town = Domesticity

= Desire for comfort and safe
place

Eating together builds trust

Day lily



Judas tree







Challenges Facing Edible Towns/Landscapes

- Legal obstacles
- Social obstacles
- Pruning and harvesting
- Care work

High Level Of Indirect Profitability

- **Community work project**
- **Positive role model and good example**
- **Motivation of social life**
- **Creates identity and solidarity**
- **New jobs**

“Fruit Streetworker“

- Marketing role
- Inform interested passers-by
- Actively approach “hesitant“ residents

- Help young and old with the harvest
- Share knowhow regarding plants and culinary distribution
- Clear and collect fallen fruit
- Take down complaints and suggestions

Edible Landscape Lasse

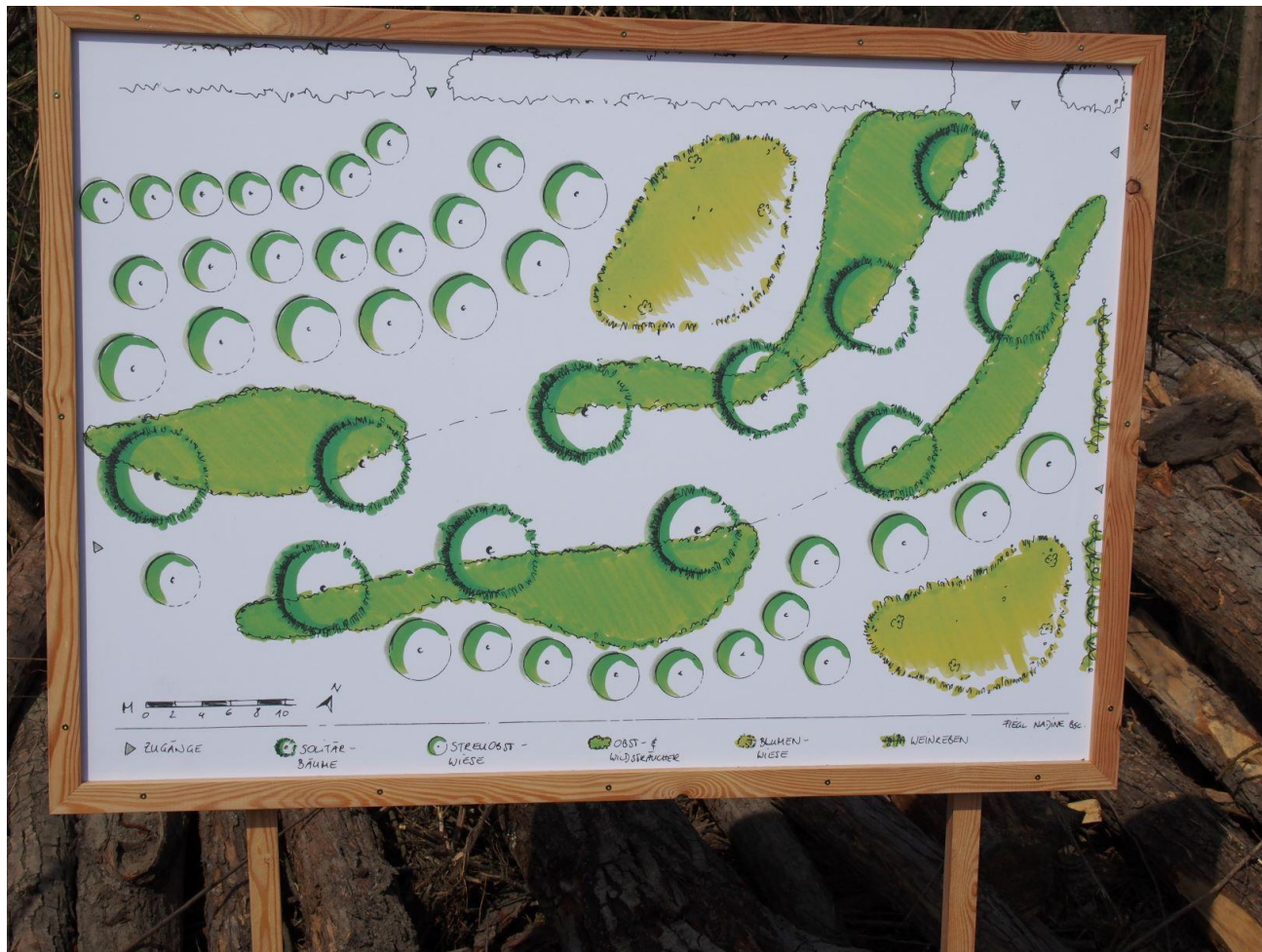

Trees for the next generation



Sowing Together



Planting Together



Watering Abundantly



Creating Together



Pride Of The Achievements



The Varieties Archive In The Public Sector

Rediscovery of old Varieties

and

Integration of New Species and
Cultivars

And...?

How will YOU implement this?

Visit us at the fruit orchard
Obstgarten Kirchberg am Wagram

Lets meet at the Edible Landscape Lassees

Let's share our experiences!

www.sigi-tatschl.at ©